



MODEL 255

Single Sliding Stainless Steel Door System U.L. Rated
Fire Door System (up to 90 minute “B” label)



THE INDUSTRY’S UNPARALLELED DOOR SYSTEM OF CHOICE

Cleanseal’s U.L. rated stainless steel sliding fire door system is designed, engineered and precision manufactured with over 30 years of experience partnering with the leading pharmaceutical companies and architects across the country. With our inclusive program we can engineer a complete interlock/access control system, packaged with the doors, to ensure flawless installation and start-up.

Using cutting-edge technology and exacting criteria for quality, these doors have surpassed market demands and exceed cGMP, FDA and EU requirements. Our quest for uncompromising quality, and our steadfast commitment to meet our customers’ ever-changing expectations, is evident in our ability to provide a comprehensive single source for all their door, hardware and integration needs.



EXCEPTIONALLY CLEAN

16 ga. 304 #4 stainless steel panel will not fade or corrode even when exposed to chemical cleansing agents. Exclusive all stainless steel track and trolley assemblies are enclosed in a stainless steel sloped shroud exceeding cGMP, FDA and EMEA requirements

ULTIMATE DURABILITY

Exclusive all stainless steel heavy-duty rail and trolley assembly. 16 ga. stainless side frames and floor hardware. Heavy-duty stainless steel panel, internal steel frame and external stainless steel operator, heat treated stainless steel roller wheels, and a Kevlar reinforced drive belt, ensures efficient and continuous operation, minimizing downtime and increasing productivity.

SEAL EFFICIENCY

Utilizing a frame mounted, three-sided polyurethane perimeter gasket, coupled with a bottom sweep gasket.

SECURE INTERLOCKS

Variety of electronic and mechanical locking options to meet the strict FDA/DEA requirements.

U.L. COMPLIANT

Stainless steel panels are manufactured to meet U.L. 10B Classification.

QUALIFIED

With over 55 years of experience, our professional sales team will ensure your mission-critical requirements, while maintaining our uncompromising dedication to quality and value added service.

DESIGN AND CONSTRUCTION

DOOR SIZES

- Up to 8' x 9'

PANEL CONSTRUCTION

- 1-3/4" thick 20 ga., 304 #4 stainless steel panel U.L. rated panel
- 20 ga. stainless steel edge cap for added protection and durability
- Full perimeter gaskets: Non-marking gray polyurethane, blade type

HEADER/RAIL AND SIDE FRAME CONSTRUCTION

- 12 ga. 304 #4 stainless steel header with 3/16" stainless steel rail assembly
- 7 ga., stainless steel trolley assemblies
- Complete header and rail enclosed with a 16 ga. 304 #4 stainless sloped shroud
- 16 ga. 304 #4 stainless steel side frames with floor hardware attached (nothing mounted into the floor)
- 316 stainless steel optional

PERFORMANCE FEATURES

- 1/4 h.p. electromechanical operator with NEMA 4X control box. Alternate power source must be provided by customer; or optional battery back-up for emergency operation in case of fire
- Standard pushplate to open - time delay to close
- Reversing edge for instant stop and reverse
- Standard dual side frame mounted reversing photoeyes
- In case of power failure, power doors can be manually operated at any time

OPTIONS

- U.L. rated vision panel with standard U.L. rated sloped frame (size and material subject to U.L. guidelines)
- Touch-less activation switches
- Custom designed interlocking system
- Actuators: variety of activation devices available upon request
- Pre-announce to close kit (light/alarm/combo)
- Alternate battery back-up power source

WARRANTY

- One year limited warranty on all components

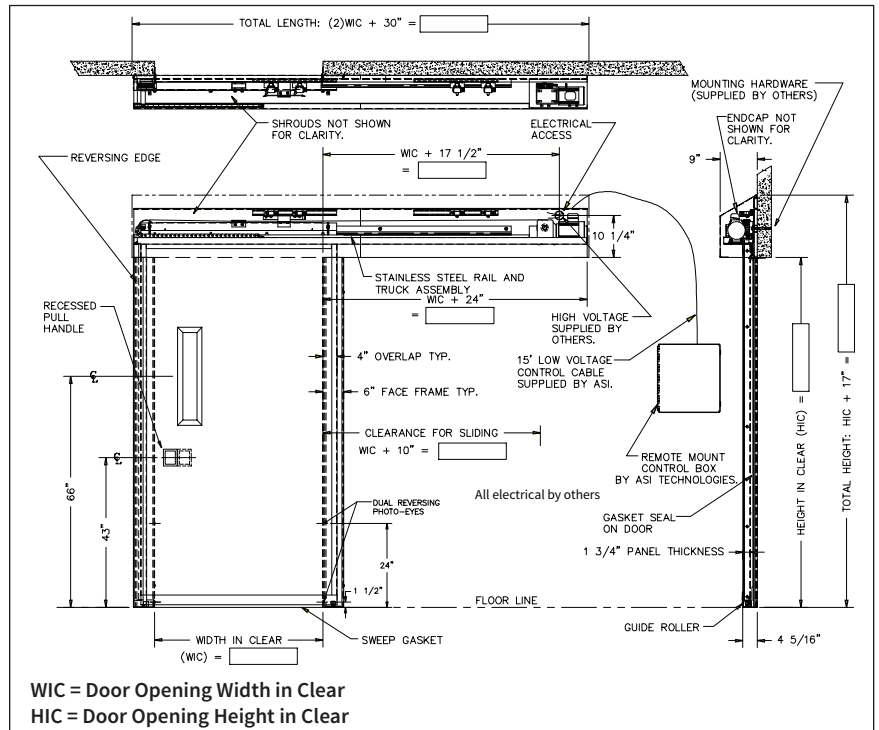

Complete Stainless Package
Our all stainless steel fire door provides the ultimate in sealing and cleanability. The tight fitting components and superior finish complement any environment.

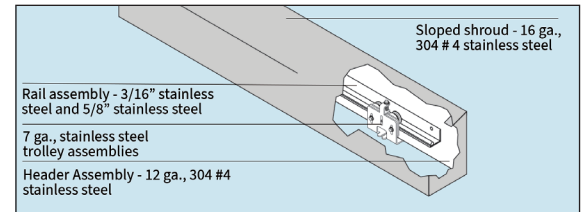

***Standard Header and Rail Assembly**
For superior cleanability, durability and aesthetic appeal