

ADVISE

FEATURES

VOLTAGE:
☐ 115V 1ø 60HZ ** ☐ 208V 1ø 60HZ ☐ 230 1ø 60HZ ☐ 460 3ø 60 HZ

CURTAIN COLOR:
☐ BLUE ☐ WHITE ☐ OTHER _____

VISION:
☒ STANDARD FULL WIDTH (28" x FULL WIDTH)

SHROUD:
☒ NONE

SHROUD & SIDE COLUMNS MATERIAL:
☒ STANDARD 304 STAINLESS STEEL

MANUAL RELEASE: (HIC >= 7'-0")
☐ YES ☒ NO

PHOTO-EYE:
☒ STANDARD SINGLE

INTERLOCK PREP: (# OF DOORS ____)
☐ YES ☒ NO

BATTERY BACKUP SYSTEM: (ONLY ON 115V UNITS)
☐ YES ☒ NO

DOOR CLOSED STATUS CONTACTS:
☐ YES ☒ NO

DOOR OPEN STATUS CONTACTS:
☐ YES ☒ NO

CONTROL PANEL:
☒ STANDARD POLYCARBONATE

EXTENDED CABLES: LENGTH = ____ (50' MAX)
☐ YES ☒ NO

HEADER SEAL KIT:
☒ STANDARD GASKET SEAL

PRE-ANNOUNCE TO CLOSE: (# OF STACKS ____)
☐ YES ☒ NO

SELECT COMPONENTS (PER STACK) MAX OF 1 ALARM PER STACK

ALARM MULTI-TONE: QTY. ____ (23A0459-1)

LIGHTS: RED QTY. ____ (23A0458-1), YELLOW QTY. ____ (23A0458-2), GREEN QTY. ____ (23A0458-3)

ACTIVATION DEVICES

- (X042) () Wall Mount, Push Plate, 2-Gang, Loose (23A227)
- (X106) () Wall Plate, Single Gang, S/S, Flush, Loose (24A0083NN20)
- (X107) () Wall Plate, 2-Gang, S/S, Flush, Loose (24A0084NN20)
- (X125) () Touchless Switch, MS11, Single Gang, Loose (23A0488)
- (X100) () Pull Cord, Unheated, Loose (24C507F1)
- (X101) () Pull Cord, Heated, Loose (24C507F2)
- (X045) () Single Button Station, Unheated, Loose (24B029F1)
- (X046) () Single Button Station, Heated, Loose (24B029F2)

SPECIAL NOTES

TAG DOOR(S) AS: *****ADVISE*****

***** ADVISE *****

- * DOOR TAG:
- * CURTAIN COLOR: BLUE OR WHITE
- * OPERATOR LOCATION: RIGHT HAND (SHOWN), LEFT IS OPPOSITE
- * VOLTAGE: 115, 208, OR 230 SINGLE PHASE OR 460 VOLTS, 3 PHASE

APPROVAL DRAWING



5848 North 95th Court
Milwaukee, WI 53225
1-800-558-7068
www.asidoors.com

TITLE
ISO-ROLL HIGH SPEED FABRIC ROLL-UP
RIGHT HAND OPERATOR

DRAWN BY	DATE	SHEET 1 OF	DRAWING NO.	REV.
----------	------	---------------	-------------	------

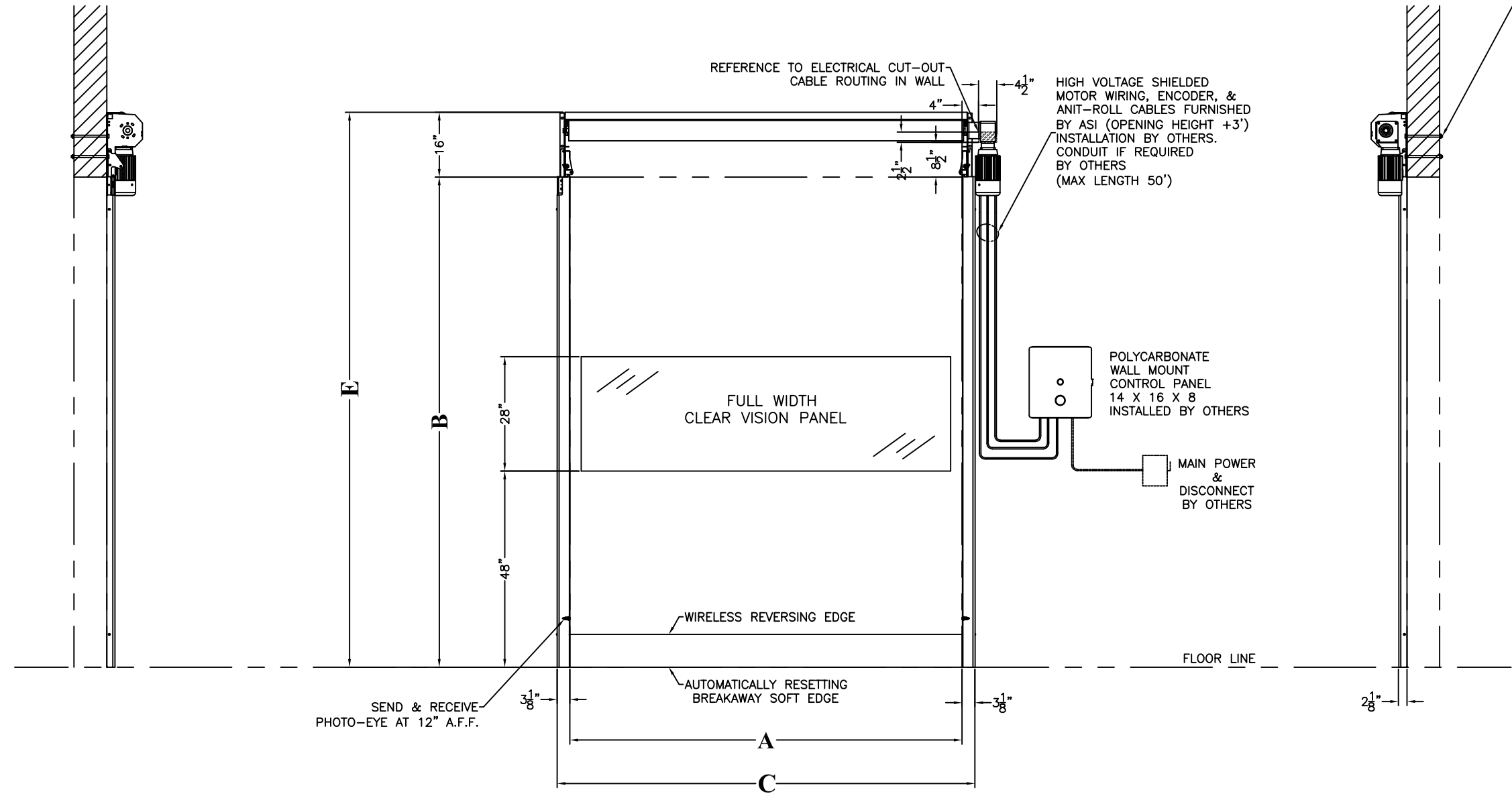

MOTOR DATA 1 HP or 2 HP	
VOLT/PHASE	RECOMMENDED SERVICE
460/3	6 AMPS
230/1	15 AMPS
208/1	15 AMPS
115/1 **	20 AMPS

NOTE: 208 & 230 VAC CONTROLS
ARE SET TO WORK WITH EITHER
SINGLE PHASE OR 3 PHASE
POWER INPUT.

** 115 VAC OPTION ONLY AVAILABLE ON DOORS 140 SQ FT OR LESS

DOOR DIMENSIONS

FINISHED OPENING WIDTH	A	8'-0"
FINISHED OPENING HEIGHT	B	10'-0"
A + 6 1/4"	C	8'-6 1/4"
A + 13"	D	9'-1"
B + 16"	E	11'-4"

APPROVALS

FABRICATION CAN PROCEED ACCORDING TO THE
SPECIFICATION SHOWN EXCEPT AS NOTED.

BY _____ DATE _____

ASI JOB NUMBER:
CUSTOMER ORDER NUMBER:
SOLD TO:
END USER:

QUANTITY OF DOORS:
DOOR MODEL NO: 415
DOOR ASSEMBLY NO: 91B0003
ELECTRICAL DRAWING NO: