

OPTIONS

DOOR PANEL MATERIAL:  
■ - WHITE STUCCO    □ - GALVANIZED    □ - 304 #4 STAINLESS STEEL

DOOR PANEL TYPE:  
■ COOLER

HEADER MATERIAL:  
■ ALUMINUM/ZINC/GALVANIZED

OPERATOR TYPE:  
■ POWERED

WALL TRACK:  
■ STAINLESS STEEL

DRIVE OPTIONS:  
■ STANDARD GEAR MOTOR W/ENCODER

VOLTAGE:  
□ - 208V 3ø 60HZ    □ - 230V 3ø 60HZ    □ - 460V 3ø 60HZ

ADVISE

MIRROR HEADER:  
■ - NONE

INSIDE TRIM:  
■ - NONE

JAMB CAPPING:  
■ - NONE

KICKPLATE:  
■ - STD 48" BREAKAWAY PANEL-INSIDE  
■ - STD 48" BREAKAWAY PANEL-OUTSIDE

LED LIGHT BAR WARNING SYSTEM:  
■ - NONE

- ACTIVATION DEVICES
- (X001)

( )

Loop Detector (55B169F7)
- (X045)

( )

Single Button Station, Unheated, Loose (24B029F1)
- (X046)

( )

Single Button Station, Heated, Loose (24B029F2)
- (X047)

( )

3-Button Station, Open/Close/E-Stop, Loose (24A001)
- (X100)

( )

Pull Cord, Unheated, Loose (24C507F1)
- (X101)

( )

Pull Cord, Heated, Loose (24C507F2)

SPECIAL NOTES

TAG DOOR(S) AS: **\*\*\*ADVISE\*\*\***

APPLICATION DATA

ADVISE

WASHDOWN ENVIRONMENT: YES ☐ OR NO ☐

NOTE: MOUNTING HARDWARE BY OTHERS

DOOR DIMENSIONS			
BUILD WIC	A		6'-0"
BUILD HIC	B		8'-0"
A/2 + 13 1/2"	C		4'-1 1/2"
2A + 27"	D		14'-3"
B + 14 1/2"	E		9'-2 1/2"

MOTOR/CONTROL SYSTEM AMP DRAW	
VOLT/PHASE	RECOMMENDED SERVICE
460/3	2.4 AMPS
230/3	4.7 AMPS
208/3	5.2 AMPS

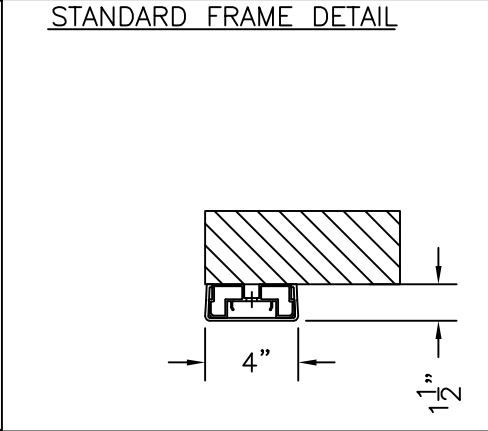
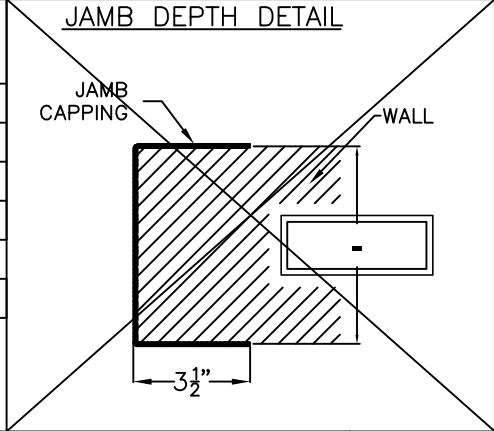

\*\*\*\*\* ADVISE \*\*\*\*\*

\* DOOR TAG:  
\* OPERATOR LOCATION: RIGHT HAND (SHOWN), LEFT IS OPPOSITE  
\* VOLTAGE: 208V 3ø OR 230V 3ø OR 460V 3ø  
\* APPLICATION DATA: WASHDOWN ENVIRONMENT - YES OR NO?  
\* MOUNT SIDE TEMP: \_\_\_\_\_  
\* OPPOSITE SIDE TEMP: \_\_\_\_\_

APPROVAL DRAWING

5848 North 95th Court  
Milwaukee, WI 53225  
1-800-558-7068  
www.asidoors.com

APPROVALS

FABRICATION CAN PROCEED ACCORDING TO THE SPECIFICATION SHOWN EXCEPT AS NOTED.

BY \_\_\_\_\_ DATE \_\_\_\_\_

ASI JOB NUMBER: \_\_\_\_\_

CUSTOMER ORDER NUMBER: \_\_\_\_\_

SOLD TO: \_\_\_\_\_

END USER: \_\_\_\_\_

QUANTITY OF DOORS: \_\_\_\_\_

DOOR MODEL NO:            IXP 2100

DOOR ASSEMBLY NO:        90D015

ELECTRICAL DRAWING NO: \_\_\_\_\_

TITLE  
BI-PART IMPACTABLE SLIDING DOOR,  
RH OPERATOR, POWERED, 4" COOLER

DRAWN BY

DATE

SHEET  
1 OF

DRAWING NO.

REV.