

| | |
|--------------------------------------------------------------------------------------------------------------------------------------------------------------------|-------------------------------------------------------------------------------------|
| OPTIONS | |
| DOOR PANEL MATERIAL: <input checked="" type="checkbox"/> - WHITE STUCCO <input type="checkbox"/> - GALVANIZED <input type="checkbox"/> - 304 #4 STAINLESS STEEL | |
| DOOR PANEL TYPE: <input checked="" type="checkbox"/> COOLER | WALL TRACK: <input checked="" type="checkbox"/> STAINLESS STEEL |
| HEADER MATERIAL: <input checked="" type="checkbox"/> ALUMINUM/ZINC/GALVANIZED | |
| OPERATOR TYPE: <input checked="" type="checkbox"/> POWERED | DRIVE OPTIONS: <input checked="" type="checkbox"/> STANDARD GEAR MOTOR W/ENCODER |
| VOLTAGE: <input type="checkbox"/> - 208V 3Ø 60HZ <input type="checkbox"/> - 230V 3Ø 60HZ <input type="checkbox"/> - 460V 3Ø 60HZ ADVISE | |
| MIRROR HEADER: <input checked="" type="checkbox"/> - NONE | |
| INSIDE TRIM: <input checked="" type="checkbox"/> - NONE | |
| JAMB CAPPING: <input checked="" type="checkbox"/> - NONE | |
| KICKPLATE: <input checked="" type="checkbox"/> - STD 48" BREAKAWAY PANEL-INSIDE <input checked="" type="checkbox"/> - STD 48" BREAKAWAY PANEL-OUTSIDE | LED LIGHT BAR WARNING SYSTEM: <input checked="" type="checkbox"/> - NONE |

- ACTIVATION DEVICES
- | | | |
|--------|-----|-----------------------------------------------------|
| (X045) | () | Single Button Station, Unheated, Loose (24B029F1) |
| (X046) | () | Single Button Station, Heated, Loose (24B029F2) |
| (X047) | () | 3-Button Station, Open/Close/E-Stop, Loose (24A001) |
| (X100) | () | Pull Cord, Unheated, Loose (24C507F1) |
| (X101) | () | Pull Cord, Heated, Loose (24C507F2) |

SPECIAL NOTES

TAG DOOR AS: *****ADVISE*****

| | |
|-----------------------------------------------------------------------------------|---------------|
| APPLICATION DATA | ADVISE |
| WASHDOWN ENVIRONMENT: YES <input type="checkbox"/> OR NO <input type="checkbox"/> | |

NOTE: MOUNTING HARDWARE BY OTHERS

| DOOR DIMENSIONS | | | |
|-----------------|---|--|------------|
| BUILD WIC | A | | 8'-0" |
| BUILD HIC | B | | 10'-0" |
| A + 16 1/2" | C | | 9'-4 1/2" |
| 2A + 20" | D | | 17'-8" |
| | | | |
| B + 14 1/2" | E | | 11'-2 1/2" |
| | | | |
| A + 15" | F | | 9'-3" |
| | | | |

| MOTOR/CONTROL SYSTEM AMP DRAW | | |
|-------------------------------|---------------------|--|
| VOLT/PHASE | RECOMMENDED SERVICE | |
| 460/3 | 2.4 AMPS | |
| 230/3 | 4.7 AMPS | |
| 208/3 | 5.2 AMPS | |

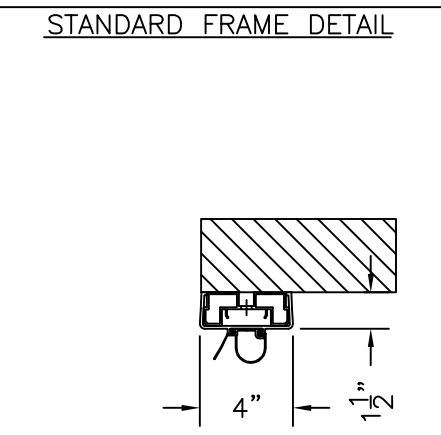
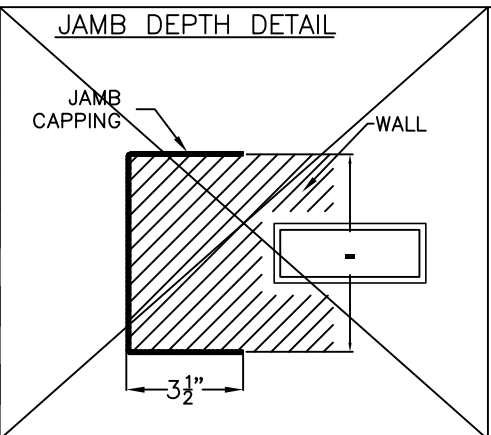

***** **ADVISE** *****

- * DOOR TAG:
- * SLIDE DIRECTION: RIGHT HAND (SHOWN), LEFT IS OPPOSITE
- * VOLTAGE: 208V 3Ø OR 230V 3Ø OR 460V 3Ø
- * APPLICATION DATA: WASHDOWN ENVIRONMENT - YES OR NO?
- * MOUNT SIDE TEMP: _____
- * OPPOSITE SIDE TEMP: _____

APPROVAL DRAWING

5848 North 95th Court
Milwaukee, WI 53225
1-800-558-7068
www.asidoors.com

| | |
|-------------------------------------------------------------------------------|------------|
| APPROVALS | |
| FABRICATION CAN PROCEED ACCORDING TO THE SPECIFICATION SHOWN EXCEPT AS NOTED. | |
| BY _____ | DATE _____ |

| |
|------------------------|
| ASI JOB NUMBER: |
| CUSTOMER ORDER NUMBER: |
| SOLD TO: |
| END USER: |

| |
|----------------------------------------------|
| QUANTITY OF DOORS: |
| DOOR MODEL NO: IXP 2600 |
| DOOR ASSEMBLY NO: 90D014 |
| ELECTRICAL DRAWING NO: |

| | | | | |
|--------------------------------------------------------------------------|------|---------------|-------------|------|
| TITLE SINGLE SLIDE IMPACTABLE DOOR, RIGHT HAND, POWERED, 4" COOLER | | | | |
| DRAWN BY | DATE | SHEET 1 OF | DRAWING NO. | REV. |