

OPPOSITE SIDE TEMPERATURE _____ ° **ADVISE**

MOUNT SIDE TEMPERATURE _____ ° **ADVISE**

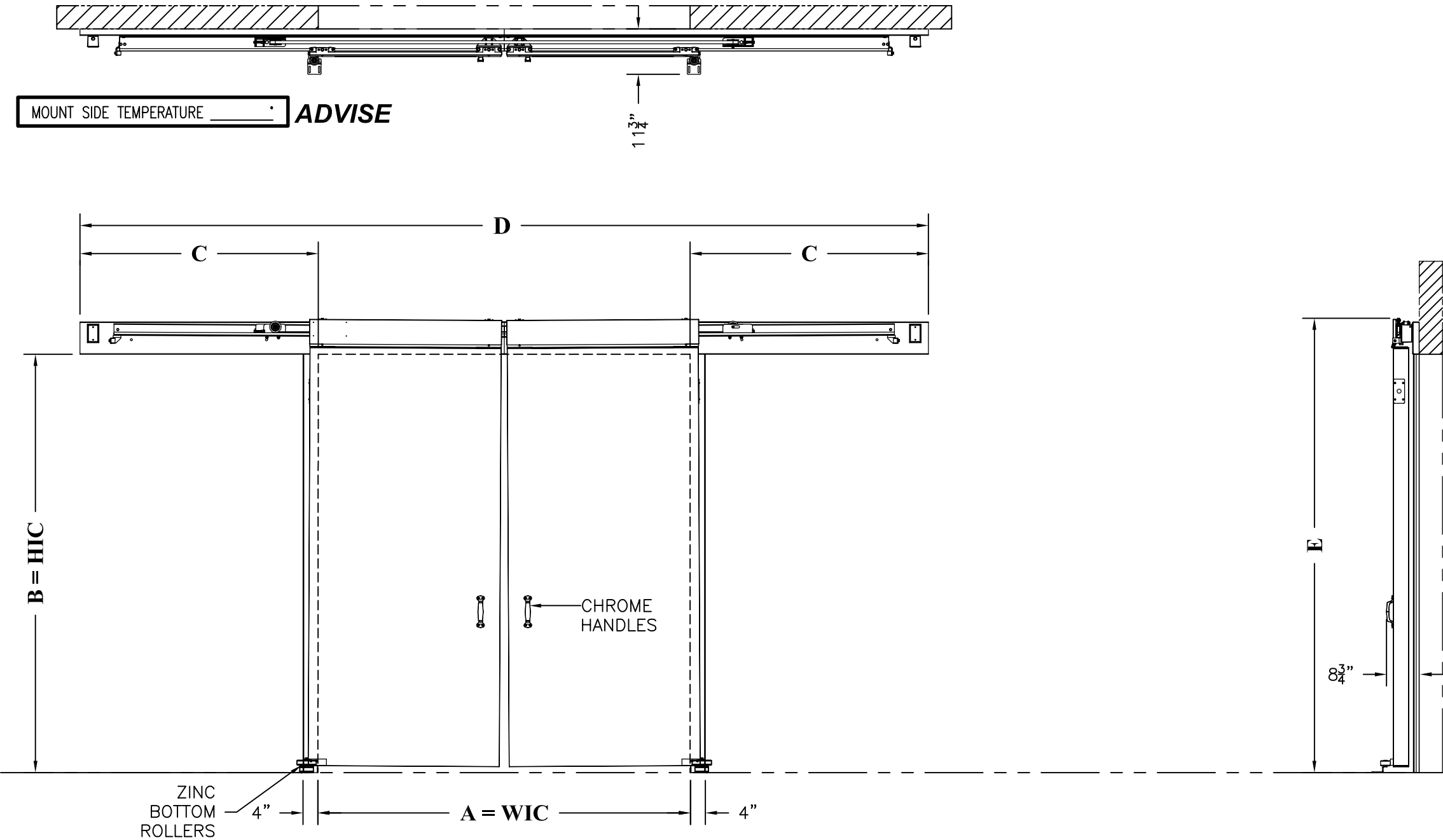

OPTIONS

DOOR PANEL MATERIAL: <input checked="" type="checkbox"/> - WHITE STUCCO <input type="checkbox"/> - FIBERGLASS <input type="checkbox"/> - 304 #4 STAINLESS STEEL	
DOOR PANEL TYPE: <input checked="" type="checkbox"/> COOLER - 4" THICK	EXTERIOR DOOR HANDLE TYPE: <input checked="" type="checkbox"/> CHROME
FLOOR ROLLER SYSTEM: <input checked="" type="checkbox"/> ZINC	FACE FRAME CONSTRUCTION: <input checked="" type="checkbox"/> ALUMINUM W/POLYPROPYLENE COVERS
HEADER MATERIAL: <input checked="" type="checkbox"/> ALUMINUM/ZINC/GALVANIZED	
OPERATOR TYPE: <input checked="" type="checkbox"/> NONE - MANUAL DOOR	
VOLTAGE: <input checked="" type="checkbox"/> NONE - MANUAL DOOR	
MIRROR HEADER: <input checked="" type="checkbox"/> - NONE	
INSIDE TRIM: <input checked="" type="checkbox"/> - NONE	
JAMB CAPPING: <input checked="" type="checkbox"/> - NONE	
KICKPLATE: <input checked="" type="checkbox"/> - NONE - INSIDE <input checked="" type="checkbox"/> - NONE - OUTSIDE	

SPECIAL NOTES

TAG DOOR(S) AS: *****ADVISE*****

***** **ADVISE** *****

- * DOOR TAG:
- * OPERATOR LOCATION: RIGHT HAND (SHOWN), LEFT IS OPPOSITE
- * VOLTAGE: 115V OR 230V 1Ø
- * APPLICATION DATA: WASHDOWN ENVIRONMENT - YES OR NO?
- * MOUNT SIDE TEMP: _____ °
- * OPPOSITE SIDE TEMP: _____ °

APPROVAL DRAWING



5848 North 95th Court
Milwaukee, WI 53225
1-800-558-7068
www.asidoors.com

TITLE
BI-PART SLIDE DOOR,
MANUAL, 4" COOLER

DRAWN BY	DATE	SHEET 1 OF	DRAWING NO.	REV.
----------	------	---------------	-------------	------

APPLICATION DATA **ADVISE**

WASHDOWN ENVIRONMENT: YES ☐ OR NO ☐

NOTE: MOUNTING HARDWARE BY OTHERS

MOTOR/CONTROL SYSTEM AMP DRAW

VOLT/PHASE	RECOMMENDED SERVICE
460/3	2.8 AMPS
230/1	5.5 AMPS
115/1	11 AMPS

NOTE: 230 VAC CONTROLS ARE SET TO WORK WITH EITHER SINGLE PHASE OR 3 PHASE POWER INPUT

DOOR DIMENSIONS

BUILD WIC	A	8'-0"
BUILD HIC	B	10'-0"
A/2 + 13 1/2"	C	5'-1 1/2"
2A + 27"	D	18'-3"
B + 11"	E	10'-11"

JAMB DEPTH DETAIL

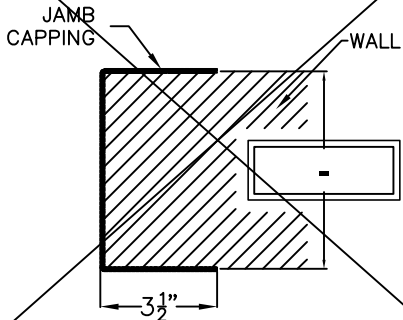

STANDARD FRAME DETAIL

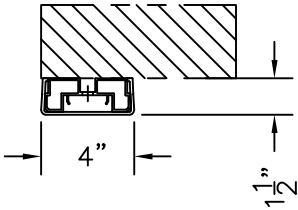

APPROVALS

FABRICATION CAN PROCEED ACCORDING TO THE SPECIFICATION SHOWN EXCEPT AS NOTED.

BY _____ DATE _____

ASI JOB NUMBER:
CUSTOMER ORDER NUMBER:
SOLD TO:
END USER:

QUANTITY OF DOORS:
DOOR MODEL NO: XP 2002
DOOR ASSEMBLY NO: 90B0002
ELECTRICAL DRAWING NO: