

APPLICATION DATA **ADVISE**
 WASHDOWN ENVIRONMENT: YES ☐ OR NO ☐

NOTE: MOUNTING HARDWARE BY OTHERS

HEAT SYSTEM AMP DRAW
 _____ AMPS @ 115V
 NOTE: 115V HEAT POWER BY OTHERS (GFCI REQUIRED)

MOTOR/CONTROL SYSTEM AMP DRAW

	VOLT/PHASE	RECOMMENDED SERVICE
	460/3	2.8 AMPS
	230/1	5.5 AMPS
	115/1	11 AMPS

NOTE: 230 VAC CONTROLS ARE SET TO WORK WITH
EITHER SINGLE PHASE OR 3 PHASE POWER INPUT.

<u>DOOR DIMENSIONS</u>		
BUILD WIC	A	8'-0"
BUILD HIC	B	10'-0"
A + 16 1/2"	C	9'-4 1/2"
2A + 20"	D	17'-8"
B + 11"	E	10'-11"

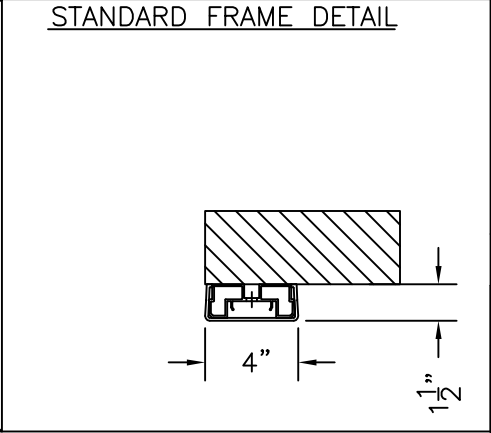
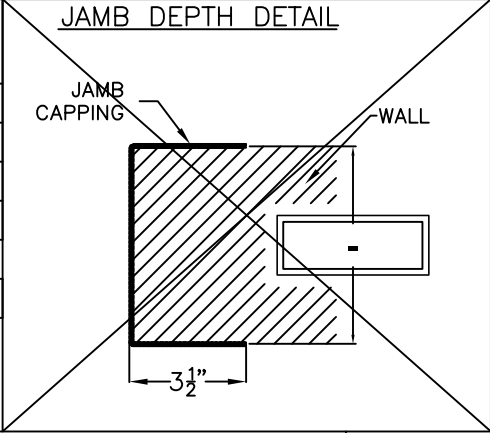

APPROVALS

FABRICATION CAN PROCEED ACCORDING TO THE
SPECIFICATION SHOWN EXCEPT AS NOTED.

BY _____ DATE _____

ASI JOB NUMBER:	
CUSTOMER ORDER NUMBER:	
SOLD TO:	
END USER:	

QUANTITY OF DOORS:
DOOR MODEL NO: XP 2502
DOOR ASSEMBLY NO: 91B0001
ELECTRICAL DRAWING NO: