



OPEN UP TO WHAT'S POSSIBLE

# MODEL 515

## High-Speed Fabric Roll-Up Door System

### THE INDUSTRY'S UNPARALLELED DOOR SYSTEM OF CHOICE

The accelerated rate of change in clean manufacturing practices, coupled with increased regulation and competitive market forces, has put increasing pressure on facility budgets. Performance and value have become inseparable key words for manufacturers worldwide. Companies producing supplements, nutraceuticals, medical devices, over-the-counter-formulations, and many others, face new challenges within their facilities as regulators expand their focus beyond traditional pharmaceutical and biotechnology manufacturing. The 515 high speed fabric roll-up doors provides an elegant solution to these new challenges.

Superior aesthetics, uncompromising quality, exceptional reliability and unmatched value define the 515 doors. Designed from the ground up to far exceed the offerings of other door manufacturers, yet priced to meet demanding budget constraints, is truly the "no compromise" clean door solution.



Shown with optional side covers and full vision panel



#### ENHANCED PRODUCTIVITY

With opening speeds up to 50" per second, the 515 fabric roll-up will provide increased material handling while minimizing air exchange and increasing energy efficiencies. Speed is fully adjustable and allows the user to tailor the door operation to exacting requirements.

#### ADVANCED TECHNOLOGY

Reliable, low maintenance, high efficiency 1 hp operator has no brakes to maintain or replace. Our standard frequency inverter, in conjunction with absolute encoder technology and micro processor controller, allows for smooth and quite soft stop/start door operations. Using flexible inverter technology, the user is allowed to choose from a variety of line side voltages, including 115 VAC single phase.

#### TIGHTEST SEAL

"Soft seal" bottom edge allows curtain to mold to the floor's contours with little or no gap and stops air infiltration from the ground up.

#### LOW PROFILE

The 515 fabric roll up door requires only 2<sup>3</sup>/<sub>4</sub>" of side room clearance and only 18<sup>1</sup>/<sub>2</sub>" of head clearance.

#### AUTOMATIC CURTAIN RESET

If a curtain becomes displaced from its track, it will automatically reset on every upward cycle. The Design requires no counterweights, springs, belts, windbars, winkknobs, coil cords or bottom bars.

#### OPTIONAL MANUAL RELEASE

If power is lost, simply push through the curtain (from either side) at the clearly marked location near the side frame and walk through. (Optional)

#### UNMATCHED QUALIFICATIONS

Our professional sales consulting team will ensure your mission-critical requirements, while maintaining our uncompromising dedication to quality and value added services.



## DESIGN AND CONSTRUCTION

### DOOR SIZES

- Up to 17' x 17' (For additional sizes - consult factory)

### PANEL CONSTRUCTION

- Multi-filament PVC coated curtain material, FDA compliant
- White or blue color curtain standard (Other colors available upon request)
- No windknobs or windbars required
- Soft bottom edge - no bottom bar required

### FRAME & SHROUD CONSTRUCTION

- Side frames constructed with 16 ga., galvanized steel
- Side frames designed for maximum durability and utilize a UHMW guide track
- Standard lintel seal

### OPERATOR FEATURES

- High performance, high efficiency, washdown rated 1 or 2 HP electric motor
- Available in 120/208/230v single-phase, or 460v three-phase power
- Absolute encoder controlled - washdown rated
- Adjustable open and close speeds up to 50"/sec. (50"/sec. open and 32"/sec. close std.)

### PERFORMANCE FEATURES

- Standard pushbutton to open and time delay to close
- Send and receive reversing photoeye (std.)
- Soft bottom edge with washdown rated wireless electronic instant reversing edge
- Breakaway curtain with automatic reset from either direction
- Manual override for opening without power at motor location

### OPTIONS

- Pull cords
- Remote push buttons
- Additional photo-eyes - actuator or reversing
- Radio control - single or multi-channel receiver
- Loop detector
- Motion detector
- Touch-less activation devices
- Custom designed interlocking system
- Barrel and operator shrouds - stainless, galvanized or white metal
- Side guide covers - stainless, galvanized or white metal
- Battery back-up system (1 hp, 115 VAC only)
- Pre-announce to close kit (light/alarm/combo)
- 28" full width PVC vision panel (consult factory for additional window options)
- Stainless Steel construction

### WARRANTY

- One year limited warranty on all components

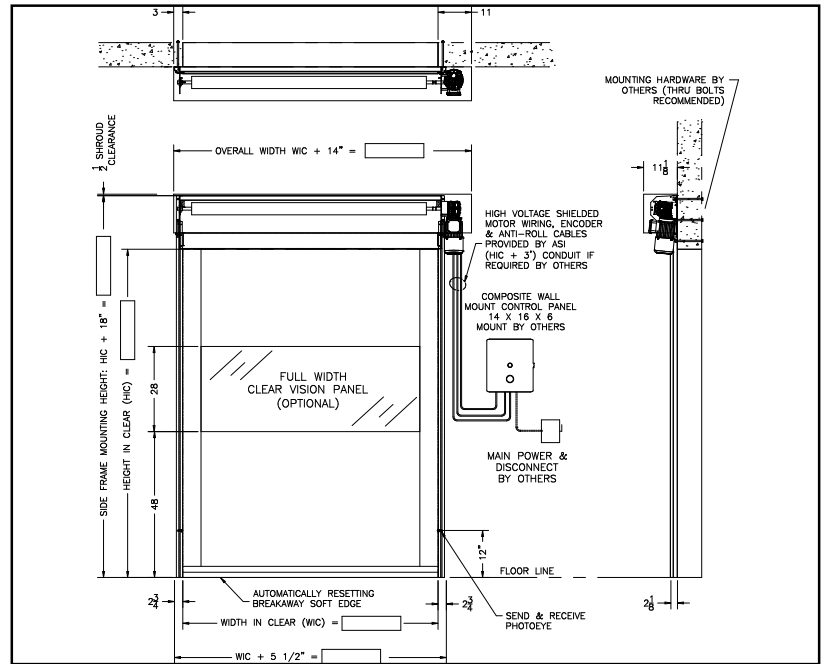

WIC = Door Opening Width in Clear  
HIC = Door Opening Height in Clear



#### Soft Bottom Edge

The ultimate safety for personnel and provides optimal sealing. Easy to clean.



#### Photo-Eye

Photo-eye interruption, will return to full open position.



#### Breakaway with Auto Reset

Impactable in either direction, curtain will automatically reset on next upward cycle.



#### Ultra Low Profile

Door requires only 2-3/4" of side room clearance.



#### Optional Side Guide Cover

The ultimate in cleanliness, and provides streamlined appearance.